

# J16金属按钮开关 Metal button switch



## ■ 特性 / Features

- 安装直径16mm
- 防护等级：IP65/IP67/IK10
- 触点银镀金：3μ
- LED超高亮冷光源灯显示
- 可定制图案，颜色及尺寸

公司电子样本浏览手机网站

[www.wzjh.cc](http://www.wzjh.cc)

了解公司最新动态及相关信息与成功应用情况



免费下载

[www.wzjh.cc](http://www.wzjh.cc)

免费的产品与技术支持，可从一处立刻下载



## ■ 符合标准 / Standard

符合IEC60947-5-1 GB14048.5标准  
Conform to IEC60947-5-1 GB14048.5 Standard

## ■ 触点方式

### Contact Style

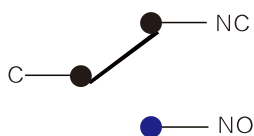

## ■ 端子描述

### Terminal Description

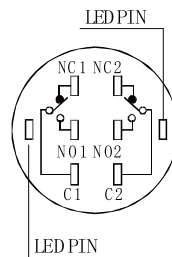

## ■ 安装尺寸 / Install Size

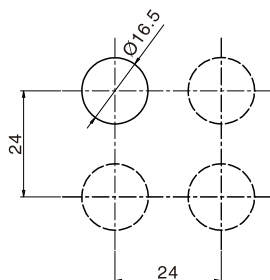

## ■ 连接器 / Connector

快速连接，安全使用，方便连接，  
线长可供定制。

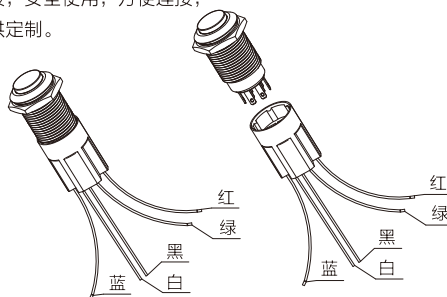

J16连接器

## ■ 开关结构说明 / Switching Operation

型式Type	No.1	No.2	No.3
符号Sign			
示意图Diagram			
说明Explanation	<p>具有两个端子的双断电慢动触头开关个别产品可定制Y型常闭开关，详见产品说明 Using two terminals, double-break and slow-motion contact. Y type NC switch can be made to order for individual product, pls check the product description.</p>		

## ■ 额定参数/ Rating

工作电压 Working voltage		24V	110V	220V	
接触参数 Contact Parameter	AC (50/60Hz)	阻性	—	1.0A	0.5A
		感性	—	0.7A	0.5A
	DC	阻性	1.0A	0.2A	—
		感性	0.7A	0.1A	—

## J16 金属按钮开关命名方式 The naming definition of J16 metal push button switch

J16	-					-	
安装尺寸 Install Size	动作方式 Action Style:	头部形状 Shape of Top:	触点形式 Contact Type:	颜色/Color:	电压/Voltage:	材料/Material:	
	2:自复按钮 3:自锁按钮 2:Momentary 3:Maintained	1:平头 2:高位头 3:弧面头 6:高面带灯 7:平面带灯 8:点头带灯 9:高点面带灯 1: Flat Round 2: High Round 3: Domed 6: High Ring Illumated 7: Ring Illumated 8: Dot Illumated 9: High Dot Illumated	1:1NO+1NC 2:2NO+2NC	<b>R</b> 红色 / Red <b>G</b> 绿色 / Green <b>B</b> 蓝色 / Blue <b>W</b> 白色 / White <b>Y</b> 黄色 / Yellow	D:24VDC E:12VDC F:6.3VDC A1:110VAC A2:220VAC	Ni:不锈钢 T:铜镀镍 G:铜镀铬 Ni:Stainless steel T: Copper Plated Ni G: Copper plated Cr	

注: 常规的定制都是不锈钢外壳, 如需铜镀镍外壳, 请在型号后面加T; 如需铜镀铬外壳, 请在型号后面加G

Note: The regular material is Stainless steel, if you want Copper Plated with Ni, please add T behind, if you want Copper Plated Cr, please add G behind.

## 触点规格 Contact Ratings

额定绝缘电压 Rated insulation voltage	250					
发热电流 Heating current I <sub>th</sub>	3A温度不超过最大额定值所允许的电流 Temperature does not exceed the maximum allowed current					
额定使用电压 Rated voltage	12V	24V	110V	220V		
额定使用电流 Rated current	交流AC 50/60Hz	电阻性负载 Resistive load	-	5A	3A	
		电感性负载 Inductive load	-	3A	2A	
	直流DC	电阻性负载 Resistive load	5A	5A	1A	0.5A
		电感性负载 Inductive load	2A	2A	0.2A	0.1A
触点材料 Contact material	银镀金 Silver Plated Gold					

## 灯珠规格 Lamp Ratings

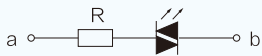
灯珠类型 Lamp Type	双向LED灯珠(交直流通用) LED lamp(AC/DC)
额定电压 Rated Voltage	3V,6V,12V,24V,36V,110V,220VAC/DC
额定电流 Rated Current	约15mA 约2mA About 15mA About 2mA
发光颜色 LED Color	<b>R</b> <b>G</b> <b>Y</b> <b>O</b> <b>B</b> <b>W</b>
寿命 Life	40000小时(参考值) 40000 hours(Reference)
灯珠等效电路 Lamp Circuit diagram	 <p>内置电阻: 采用6V灯珠, 需外接电阻。 采用交直流通用的LED灯珠, 接线端子无正负极区分; 60V以下灯珠已内置保护电阻; Using AC/DC LED lamp, the terminals have no difference of anode and cathode: Using inner resistance for the lamp below 60V. Using 6V lamp when the lamp voltage is above 60V, and need connect outer dropping resistance.</p>

注: 如需单向直流LED灯珠可定做; 其他电压规格可按需求定做。  
DC LED and other voltage can be made to order.

J系列三色灯金属按钮

带电源符号按钮

金属信号灯

经济型金属按钮

金属按钮

Ø12  
金属按钮

Ø16  
金属按钮

Ø19  
金属按钮

Ø22  
金属按钮

Ø25  
金属按钮

Ø30  
金属按钮

Ø40  
金属按钮

# 防水型金属按钮

Ø12  
金属按钮

Ø16  
金属按钮

Ø19  
金属按钮

Ø22  
金属按钮

Ø25  
金属按钮

Ø30  
金属按钮

Ø40  
金属按钮

## 主要技术参数 Technical Parameter

保护等级/Degree of Protection	IP67
触点类型/Contact Type	C:1NO+1NC/2NO+2NC
最大电压/Maximum Voltage	250V AC/DC
热流/Thermal Current	3A
最小负载/Minimum Applicable Load	5V AC/DC, 1mA
触点材料/Contact material	Silver plated glod
端子形式/Terminal Style	.110" Solder/ Quick Connect
运行温度/Operating Temperature	-25° to +55°C
操作湿度/Operating Humidity	45 to 85% RH
接触电阻/Contact Resistance	50MΩ maximum
绝缘电阻/Insulation Resistance	100MΩ minimum (500V DC megger)
震荡电阻/Vibration Resistance	10 to 55Hz, amplitude 1.2mm p-p
保护等级/Degree of Protection	>10g
电气寿命/Electrical Life	100,000 operations minimum (at full rated load)
机械寿命/Mechanical Life	Maintained: 1,000,000 operations minimum Momentary: 1,000,000 operations minimum
耐压/Dielectrical Life	Switch Unit: 2,000V AC, 1 min. between live/dead part and terminals of different poles; 1,000V AC, 1 minute between terminals of the same pole; 1,500V AC, 1 minute between contact and lamp terminals. Illumination Unit: 2,000V AC, 1 min. between live part/ground
锡焊温度/Soldering Temperature	20W/5 seconds or 260°C/3 seconds

## Ø16金属防水按钮开关 Metal Waterproof Push Button Switch

名称/外观 Product appearance	带灯形式 Illuminated type	操作类别 Operation	触点 Contact	产品型号 Model	外壳材料 Crust Material
实面圆形 / Flat round 	不带灯 Without LED	自复 Momentary	1NO+1NC	<b>J16-211</b>	Ni:不锈钢 T:铜镀镍 G:铜镀铬 Ni:Stainless steel T: Copper Plated Ni G: Copper plated Cr
			2NO+2NC	<b>J16-212</b>	
		自锁 Maintained	1NO+1NC	<b>J16-311</b>	
			2NO+2NC	<b>J16-312</b>	
高面圆形 / High round 	不带灯 Without LED	自复 Momentary	1NO+1NC	<b>J16-221</b>	
			2NO+2NC	<b>J16-222</b>	
		自锁 Maintained	1NO+1NC	<b>J16-321</b>	
			2NO+2NC	<b>J16-322</b>	

### 平钮



单刀/1Pole  
双刀/2Pole

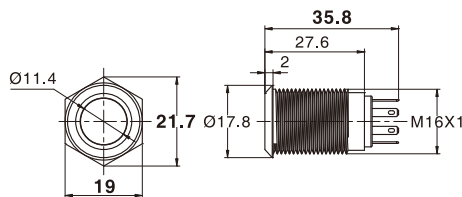

### 高位钮



单刀/1Pole  
双刀/2Pole

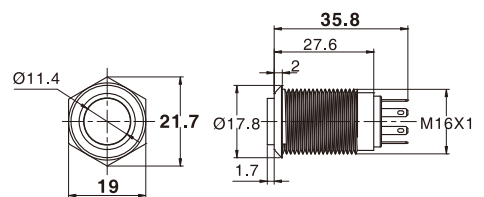

## Ø16带灯金属防水按钮开关 Metal Waterproof Push Button Switch with LED

名称/外观 Product appearance	带灯形式 Illuminated type	操作类别 Operation	触点 Contact	产品型号 Model	外壳材料 Crust Material	带灯颜色 Color	额定电压 Rated Voltage
高面环形圆形 / High ring round 	带灯 With LED	自复 Momentary	1NO+1NC	<b>J16-261</b> □●	Ni: 不锈钢 T: 铜镀镍 G: 铜镀铬 Ni: Stainless steel T: Copper Plated Ni G: Copper plated Cr	请用下列颜色编码 替换型号中的"□" <b>R</b> 红色/Red <b>G</b> 绿色/Green <b>Y</b> 黄色/Yellow <b>W</b> 白色/White <b>B</b> 蓝色/Blue	请用下列颜色编码 替换型号中的"●" D: 24VDC E: 12VDC F: 6.3VDC A1: 110VAC A2: 220VAC
			2NO+2NC	<b>J16-262</b> □●			
		自锁 Maintained	1NO+1NC	<b>J16-361</b> □●			
			2NO+2NC	<b>J16-362</b> □●			
实面环形圆形 / Flat ring round 	带灯 With LED	自复 Momentary	1NO+1NC	<b>J16-271</b> □●			
			2NO+2NC	<b>J16-272</b> □●			
		自锁 Maintained	1NO+1NC	<b>J16-371</b> □●			
			2NO+2NC	<b>J16-372</b> □●			
实面点头圆形 / High point round 	带灯 With LED	自复 Momentary	1NO+1NC	<b>J16-281</b> □●			
			2NO+2NC	<b>J16-282</b> □●			
		自锁 Maintained	1NO+1NC	<b>J16-381</b> □●			
			2NO+2NC	<b>J16-382</b> □●			
高面点头圆形 / High point round 	带灯 With LED	自复 Momentary	1NO+1NC	<b>J16-291</b> □●			
			2NO+2NC	<b>J16-292</b> □●			
		自锁 Maintained	1NO+1NC	<b>J16-391</b> □●			
			2NO+2NC	<b>J16-392</b> □●			

J 系列三色灯金属按钮

带电源符号按钮

金属信号灯

经济型金属按钮

金属按钮

Ø12  
金属按钮

Ø16  
金属按钮

Ø19  
金属按钮

Ø22  
金属按钮

Ø25  
金属按钮

Ø30  
金属按钮

Ø40  
金属按钮

高位钮带灯



单刀/1Pole  
双刀/2Pole

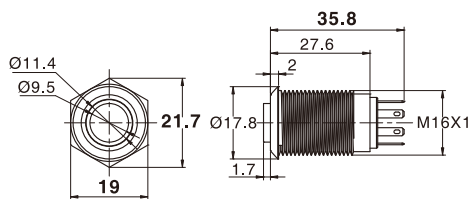

平钮带灯



单刀/1Pole  
双刀/2Pole

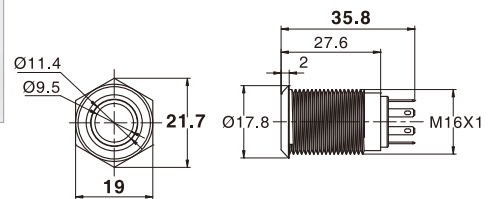

平钮带点头灯



单刀/1Pole  
双刀/2Pole

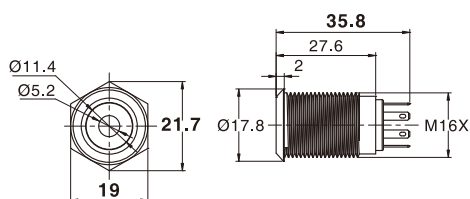

高位钮带点头灯



单刀/1Pole  
双刀/2Pole

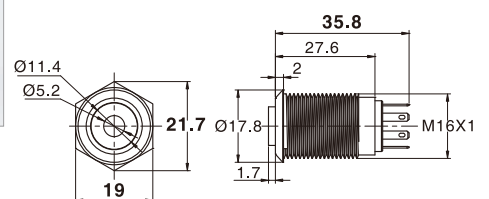

# 防水型金属按钮

## Ø16金属防水按钮开关 Metal Waterproof Push Button Switch

名称/外观 Product appearance	带灯形式 Illuminated type	操作类别 Operation	触点 Contact	产品型号 Model	外壳材料 Crust Material
实面圆形 / Flat round 	不带灯 Without LED	自复 Momentary	1NO+1NC	<b>J16-211-E</b>	Ni:不锈钢 T:铜镀镍 G:铜镀铬 Ni:Stainless steel T: Copper Plated Ni G: Copper plated Cr
			2NO+2NC	<b>J16-212-E</b>	
		自锁 Maintained	1NO+1NC	<b>J16-311-E</b>	
			2NO+2NC	<b>J16-312-E</b>	
高面圆形 / High round 	不带灯 Without LED	自复 Momentary	1NO+1NC	<b>J16-221-E</b>	
			2NO+2NC	<b>J16-222-E</b>	
		自锁 Maintained	1NO+1NC	<b>J16-321-E</b>	
			2NO+2NC	<b>J16-322-E</b>	

Ø12  
金属按钮

Ø16  
金属按钮

Ø19  
金属按钮

Ø22  
金属按钮

Ø25  
金属按钮

Ø30  
金属按钮

Ø40  
金属按钮

平钮



单刀/1Pole  
双刀/2Pole

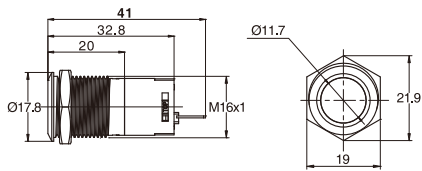

高位钮



单刀/1Pole  
双刀/2Pole

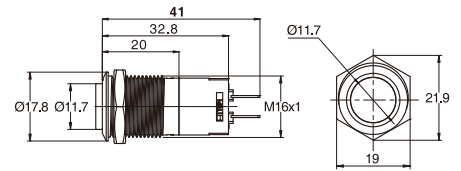

## Ø16带灯金属防水按钮开关 Metal Waterproof Push Button Switch with LED

名称/外观 Product appearance	带灯形式 Illuminated type	操作类别 Operation	触点 Contact	产品型号 Model	外壳材料 Crust Material	带灯颜色 Color	额定电压 Rated Voltage
高面环形圆形 / High ring round 	带灯 With LED	自复 Momentary	1NO+1NC	<b>J16-261-E</b> □ ●	Ni:不锈钢 T:铜镀镍 G:铜镀铬 Ni:Stainless steel T: Copper Plated Ni G: Copper plated Cr	请用下列颜色编码 替换型号中的"□" R 红色/Red G 绿色/Green Y 黄色/Yellow W 白色/White B 蓝色/Blue	请用下列颜色编码 替换型号中的"●" D:24VDC E:12VDC F:6.3VDC A1:110VAC A2:220VAC
			2NO+2NC	<b>J16-262-E</b> □ ●			
		自锁 Maintained	1NO+1NC	<b>J16-361-E</b> □ ●			
			2NO+2NC	<b>J16-362-E</b> □ ●			
实面环形圆形 / Flat ring round 	带灯 With LED	自复 Momentary	1NO+1NC	<b>J16-271-E</b> □ ●			
			2NO+2NC	<b>J16-272-E</b> □ ●			
		自锁 Maintained	1NO+1NC	<b>J16-371-E</b> □ ●			
			2NO+2NC	<b>J16-372-E</b> □ ●			
实面点头圆形 / High point round 	带灯 With LED	自复 Momentary	1NO+1NC	<b>J16-281-E</b> □ ●			
			2NO+2NC	<b>J16-282-E</b> □ ●			
		自锁 Maintained	1NO+1NC	<b>J16-381-E</b> □ ●			
			2NO+2NC	<b>J16-382-E</b> □ ●			
高面点头圆形 / High point round 	带灯 With LED	自复 Momentary	1NO+1NC	<b>J16-291-E</b> □ ●			
			2NO+2NC	<b>J16-292-E</b> □ ●			
		自锁 Maintained	1NO+1NC	<b>J16-391-E</b> □ ●			
			2NO+2NC	<b>J16-392-E</b> □ ●			

J 系列三色灯金属按钮

带电源符号按钮

金属信号灯

经济型金属按钮

金属按钮

Ø12  
金属按钮

Ø16  
金属按钮

Ø19  
金属按钮

Ø22  
金属按钮

Ø25  
金属按钮

Ø30  
金属按钮

Ø40  
金属按钮

### 高位钮带灯



单刀/1Pole  
双刀/2Pole

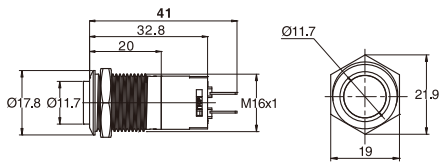

### 平钮带灯



单刀/1Pole  
双刀/2Pole

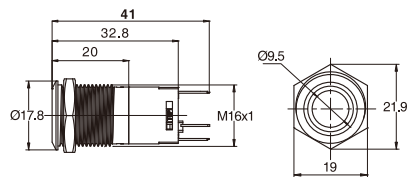

### 平钮带点头灯



单刀/1Pole  
双刀/2Pole

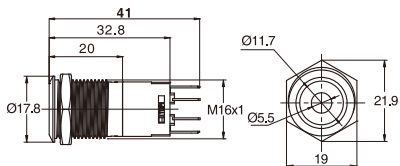

### 高位钮带点头灯



单刀/1Pole  
双刀/2Pole

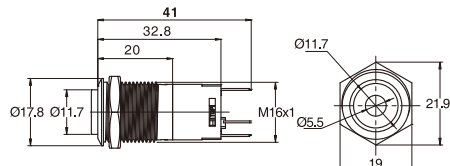

J16-E 金属按钮开关命名方式 The naming definition of J19 metal push button switch

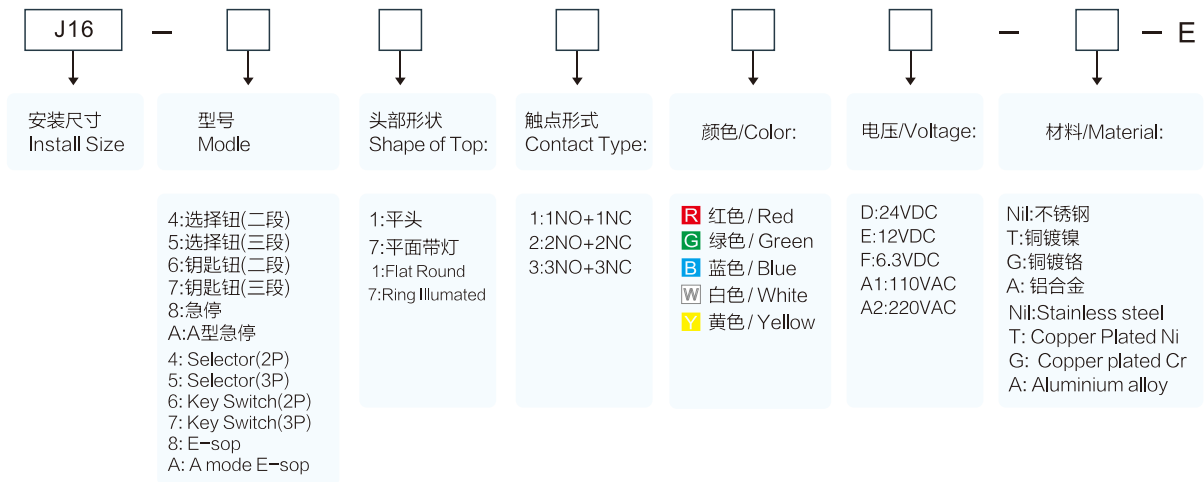

注: 常规的定制都是不锈钢外壳, 如需铜镀镍外壳, 请在型号后面加T; 如需铜镀铬外壳, 请在型号后面加G  
 Note: The regular material is Stainless steel, if you want Copper Plated with Ni, please add T behind, if you want Copper Plated Cr, please add G behind.

Ø12  
金属按钮

Ø16  
金属按钮

Ø19  
金属按钮

Ø22  
金属按钮

Ø25  
金属按钮

Ø30  
金属按钮

Ø40  
金属按钮

Ø16选择/钥匙金属开关 Selector and Key Metal Switch

通过旋转独特的锁定结构型法兰盘即可改变选择位。且, 法兰盘具备每旋转45° 即可固定的锁定功能, 所以法兰盘无旋转偏移, 面板安装容易。

选择角的位置变更方法

【3位选择形状例】

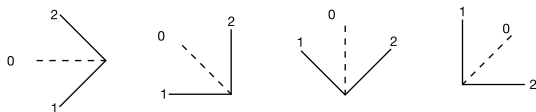

出厂时的选择位位置

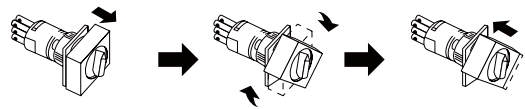

首先将法兰盘用力拉出解除锁定, 即可旋转法兰盘。选择角的位置在任意45° 的位置上按下即可进行锁定。

选择钮, 钥匙钮手柄位置/Selector and Key Switch Handle Positon

操作位规格 Operation		触点 Contact	↙	↑	↗
90° 2位 2 Positon	L R 自锁 Maintained	单刀 SPDT	NO NC C		NO NC C
	L R 自复 Momentary	双刀 DPDT	NO NC NO NC C C		NO NC NO NC C C
90° 3位 3 Positon	L C R 自锁 Maintained	三刀 TPDT	NO NC NO NC C C C	NO NC NO NC C C C	NO NC NO NC C C C
	L C R 左锁右复 Left lock Right reset		NO NC NO NC C C C	NO NC NO NC C C C	NO NC NO NC C C C
	L C R 左复右锁 Left reset Right lock		NO NC NO NC C C C	NO NC NO NC C C C	NO NC NO NC C C C
	L C R 自复 Momentary		NO NC NO NC C C C	NO NC NO NC C C C	NO NC NO NC C C C



## Ø16选择/钥匙金属开关 Selector and Key Metal Switch

名称/外观 Product appearance	带灯形式 Illuminated type	操作位规格 Operation		触点 Contact	产品型号 Model	带灯颜色 Color	额定电压 Rated Voltage
选择开关 Selector Switch 	不带灯 Without LED	90° 2位 2 Positon		单刀/SPDT	<b>J16-411-E</b>	请用下列颜色编码 替换型号中的"□" R 红色/Red G 绿色/Green Y 黄色/Yellow W 白色/White B 蓝色/Blue	请用下列颜色编码 替换型号中的"●" D:24VDC E:12VDC F:6.3VDC A1:110VAC A2:220VAC
		90° 3位 3 Positon		双刀/DPDT	<b>J16-412-E</b>		
	带灯 With LED	90° 2位 2 Positon		单刀/SPDT	<b>J16-471-E</b> □ ●		
		90° 3位 3 Positon		双刀/DPDT	<b>J16-472-E</b> □ ●		
钥匙开关 Key Switch 		自锁 Maintained	90° 2位 2 Positon	单刀/SPDT	<b>J16-611-E</b>		
			90° 2位 2 Positon	双刀/DPDT	<b>J16-612-E</b>		
			90° 3位 3 Positon	双刀/DPDT	<b>J16-712-E</b>		

选择开关

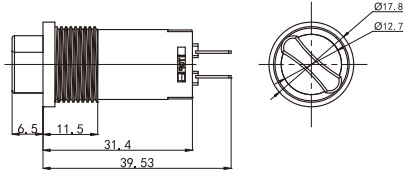

钥匙开关

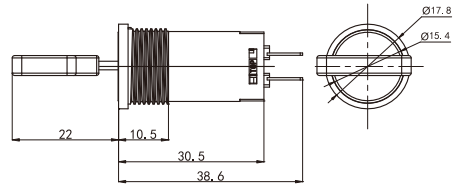

J系列三色灯金属按钮

带电源符号按钮

金属信号灯

经济型金属按钮

金属按钮

Ø12  
金属按钮

Ø16  
金属按钮

Ø19  
金属按钮

Ø22  
金属按钮

Ø25  
金属按钮

Ø30  
金属按钮

Ø40  
金属按钮